

HEPA Filter

High temperature HEPA filters
99.97% efficient at 0.3 microns.

Made with microfine glass media,
aluminum separators with a high
temperature silicone sealant in a
galvannealed steel frame and a
high temperature silicone gasket.

All filters are individually tested
per MIL-STD-282 and
IEST-RP-CC001.3

Capacities:
1,000 CFM
1,500 CFM

For other sizes, capacities or high
temperature filters with stainless
steel frames, please contact us at
414-962-5323 or
cservice@esca-tech.com

High Temperature

to 500 °F
260 °C



Technical Specifications

Frame:	18 ga. Galvannealed steel
Sealant:	High temperature silicone
Gasket:	High temperature, downstream
Efficiency:	99.97% @ 0.3 microns
NO. of pleats:	90 pleats
Maximum Temp:	Continuous operation up to 500 °F (260 °C)

ESCA Tech offers a complete line of HEPA filters

For other sizes, capacities or high temperature filters with stainless steel frames,
please contact us at 414-962-5323 or cservice@esca-tech.com



3747 N. Booth Street

Milwaukee, WI 53212 USA

Phone: (414) 962-5323

Fax: (414) 962-7003

www.esca-tech.com

HIGH TEMPERATURE HEPA FILTER

1,000 CFM CAPACITY

STEEL FRAME 1000 CFM HIGH TEMP HEPA

Part No: 1F2424XBFF4*4
 Size: 24" x 24" x 5.875"
 Efficiency: 99.99% at 0.3 microns
 Frame: 18 gauge galvanized steel,
 Frame Style: C-Style box construction
 Media Area: Approximately 144 sq. ft. glass media
 Separators: Corrugated aluminum
 Gasket: High temperature silicone
 * = 1 for downstream (stock)
 * = 2 for upstream
 * = 3 for both sides
 = 3 for both sides
 Sealant: High temperature silicone
 Less than 1.16" W.C. at 1,000 CFM
 Capacity: Continuous operation up to 500 °F
 Maximum Temp: (260 °C)

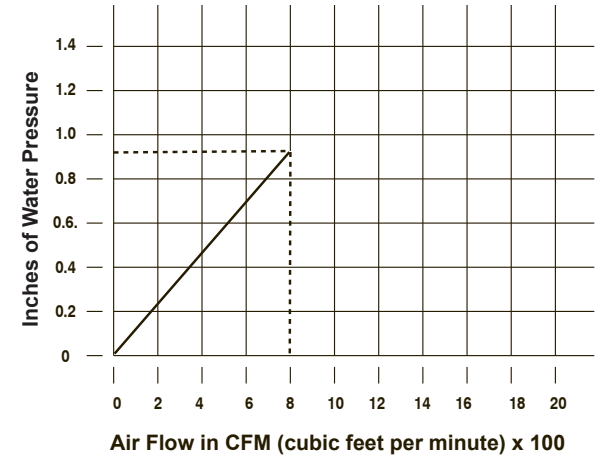
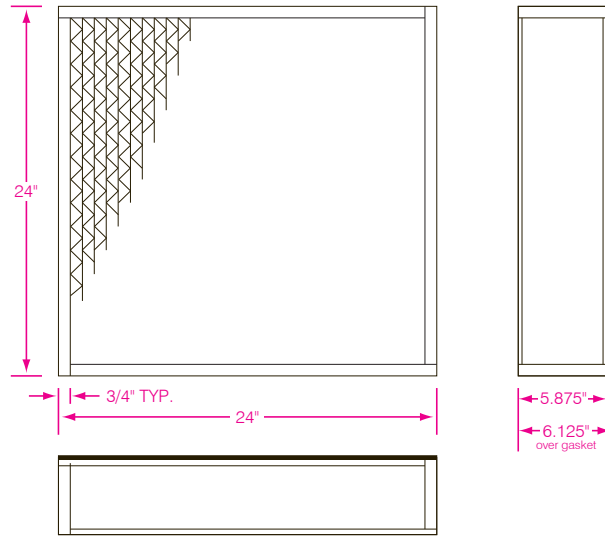

1,500 CFM CAPACITY

STEEL FRAME 1500 CFM HIGH TEMP HEPA

Part No: 1F2424XCFF4*4
 Size: 24" x 24" x 11.5"
 Efficiency: 99.97% at 0.3 microns
 Frame: 18 gauge galvanized steel,
 Frame Style: C-Style box construction
 Media Area: Approximately 220 sq. ft. glass media
 Separators: Corrugated aluminum
 Gasket: High temperature silicone
 * = 1 for downstream (stock)
 * = 2 for upstream
 * = 3 for both sides
 Sealant: High temperature silicone
 1" W.C. at 1,500 CFM
 Capacity: Continuous operation up to 500 °F
 Maximum Temp: (260 °C)

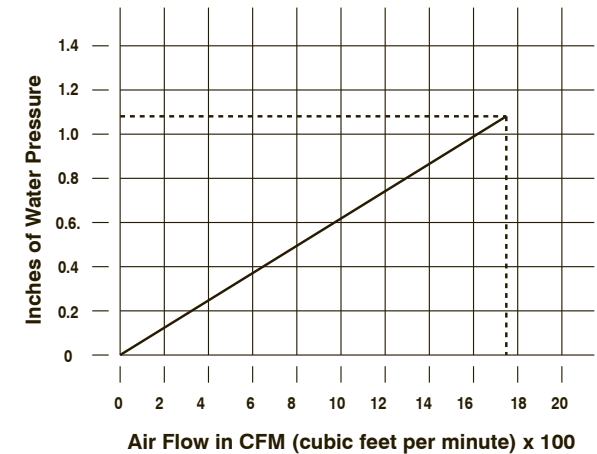
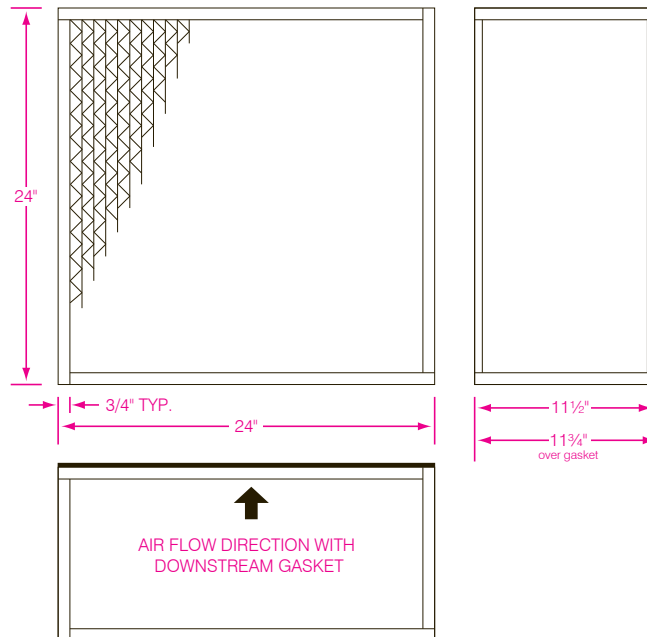

ESCA TECH, INC.

Contamination Control Systems & Solutions
 Milwaukee, WI 53212 Phone (414) 962-5323

DRAWN BY: SAMIRA.N	DATE	SCALE
	10/4/2018	NTS
SYN	REVISIONS	DATE

This drawing is the property of ESCA Tech, Inc. and is not to be used except in connection with our work. All rights of design or invention are reserved.

DRAWING NO. 1F2424BFF4*4 SHEET 1 OF 1
 HIGH TEMP HEPA FILTER

For other sizes, capacities or high temperature filters with stainless steel frames, please contact us at 414-962-5323 or cservice@esca-tech.com